

YOUR CHURCH

# WEDDING



THE CHURCH  
OF ENGLAND

YOUR CHURCH

# WEDDING

## Basford & Wolstanton 2022



THE CHURCH  
OF ENGLAND





- **Get to know each other a little better**
- **Establish lines of communication**
- **Answer any urgent questions**
- **Think about some practicalities**
- **Be sure about legalities**
- **Note resources for readings and prayers**
- **Consider musical requirements**



**You will be given...**

**Words of the marriage service  
and a link to some...**

- **suggested readings**
- **suggested prayers**
- **popular hymns and music**

# Fees for 2022





## Costs

**The total cost of your wedding ceremony comprises two elements:**

- (i) Statutory Fees***
- (ii) Local Fees***



## Costs

- (i) ***Statutory Fees:-***  
**(Non-negotiable)**

**Covers: Service / Banns /  
Certificate / Parochial Church  
Council Fee**



## Costs

(ii) *Local:*  
**(Optional)**

**Covers: Organist / Verger /  
Shared Contribution Towards  
Heating**





**Total Cost =**

**+**      **Statutory  
Organist  
Verger  
Heating**

---

**£685.00**



Cost =

Statutory  
Organist  
Verger  
Heating

+

£72.00

---

£685.00



Cost =

Statutory  
Organist  
**Verger**  
Heating

+

**£62.00**

---

**£685.00**



Cost =

Statutory  
Organist  
Verger

+

Heating

£39.00

---

£685.00

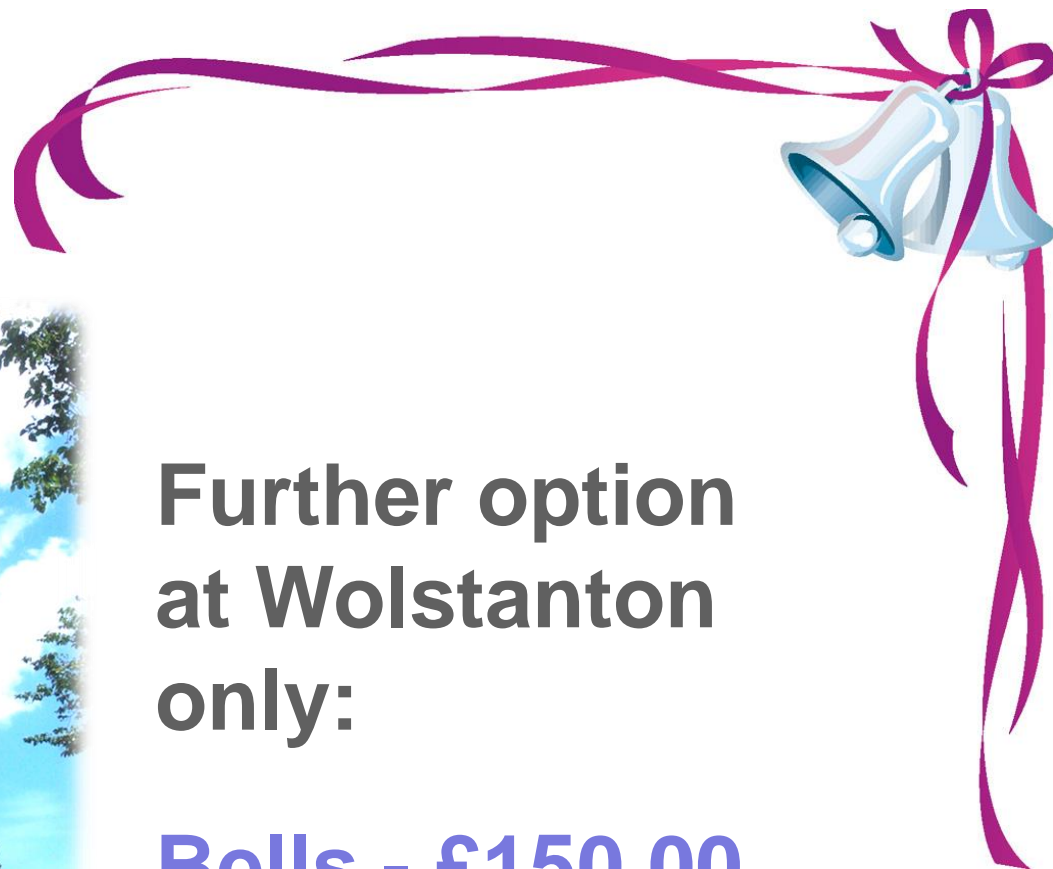

**Further option  
at Wolstanton  
only:**

**Bells - £150.00**



## Payment

*When are the fees due?*

**Normally at the rehearsal either in cash or by cheque made payable to...**

**“St. Mark’s PCC - Basford”**

**“St. Margaret’s Church”**

# Legal Matters





## **UK / EU Citizenship**

**Your UK or EU citizenship must be verified by production of a valid passport or birth certificate.**



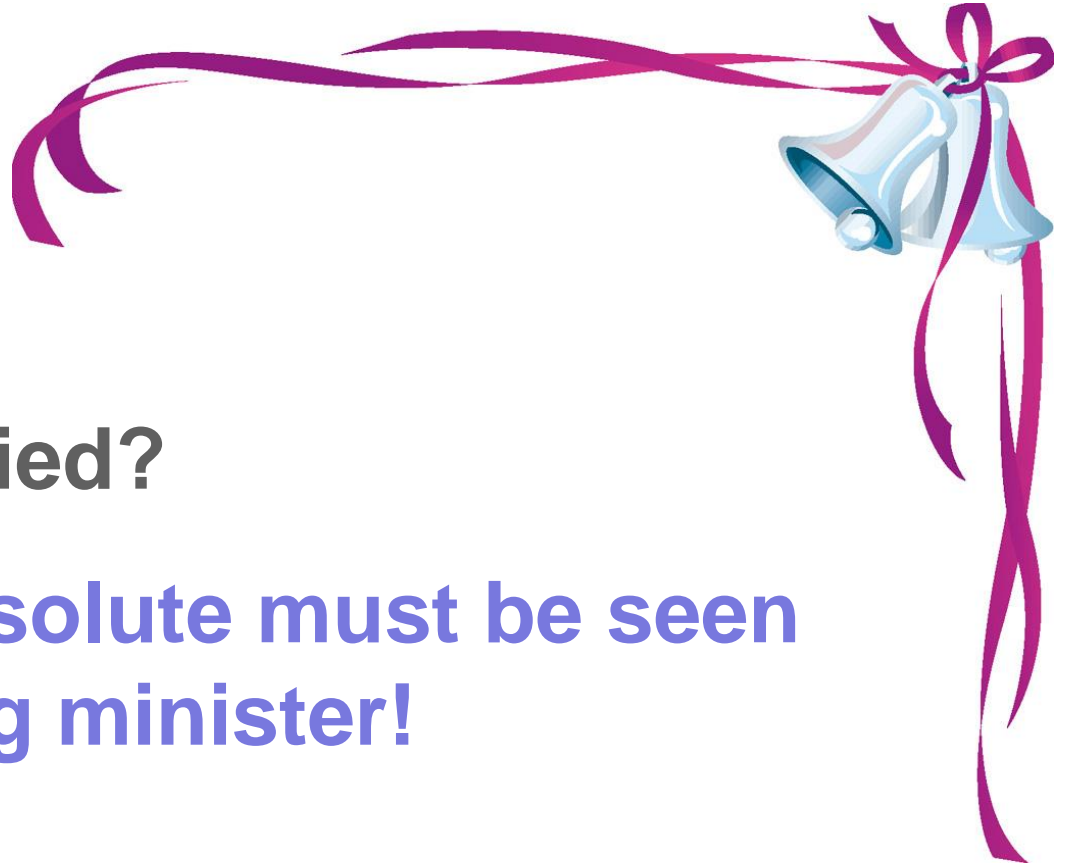

**Previously Married?**

**Your Decree Absolute must be seen  
by the officiating minister!**



## Banns of Marriage

*What are they?*

**A declaration of your intention to marry read during public worship.**



## Banns of Marriage

*When are they read?*

**On three (normally consecutive)  
Sundays before the wedding during  
the main worship service.**



## Banns of Marriage

Once read and no legal objections have been cited, they are valid for three months.



## Banns of Marriage

*Where are they read?*

- a) The church where you will marry
- b) The groom's parish church
- c) The bride's parish church

*One or more of these may be the same place!*



## **Banns of Marriage**

**We will automatically read your  
Banns at either St. Mark's and / or  
St. Margaret's.**



## Banns of Marriage

If either of you are living in a parish other than that belonging to the church where you are marrying, **you must apply to have your Banns read at your own parish church!**

**We require a Banns Certificate (costing £48.00) issued by its minister.**



## **Banns of Marriage**

**We normally start publishing Banns on the first Sunday of the month which maximises their validity.**

**For Example: Marriage in July  
Banns start in May**





## Changes of Address

If you move home, please let us  
Know.

***It will have legal implications!***

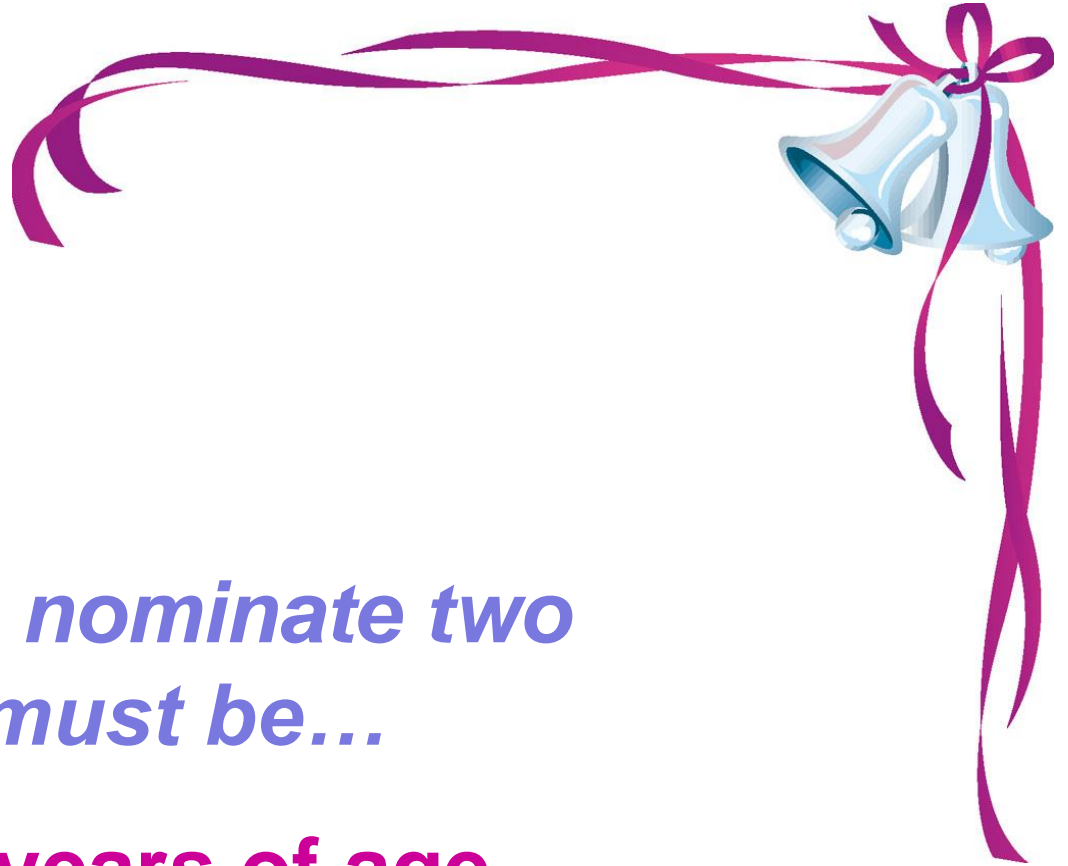

## Witnesses

*You will need to nominate two witnesses who must be...*

- a) At least 18 years of age**
- b) UK Citizens**
- c) Present the entire service**

# Practical Matters





## **Rehearsal**

**A rehearsal is always a good idea!**

**We can arrange rehearsals to suit your circumstances.**



## Rehearsal

*Who should attend?*

**Chief Bridesmaid**

**The 'Giver Away'**

**Best Man**

**Bridesmaids and Pageboys**

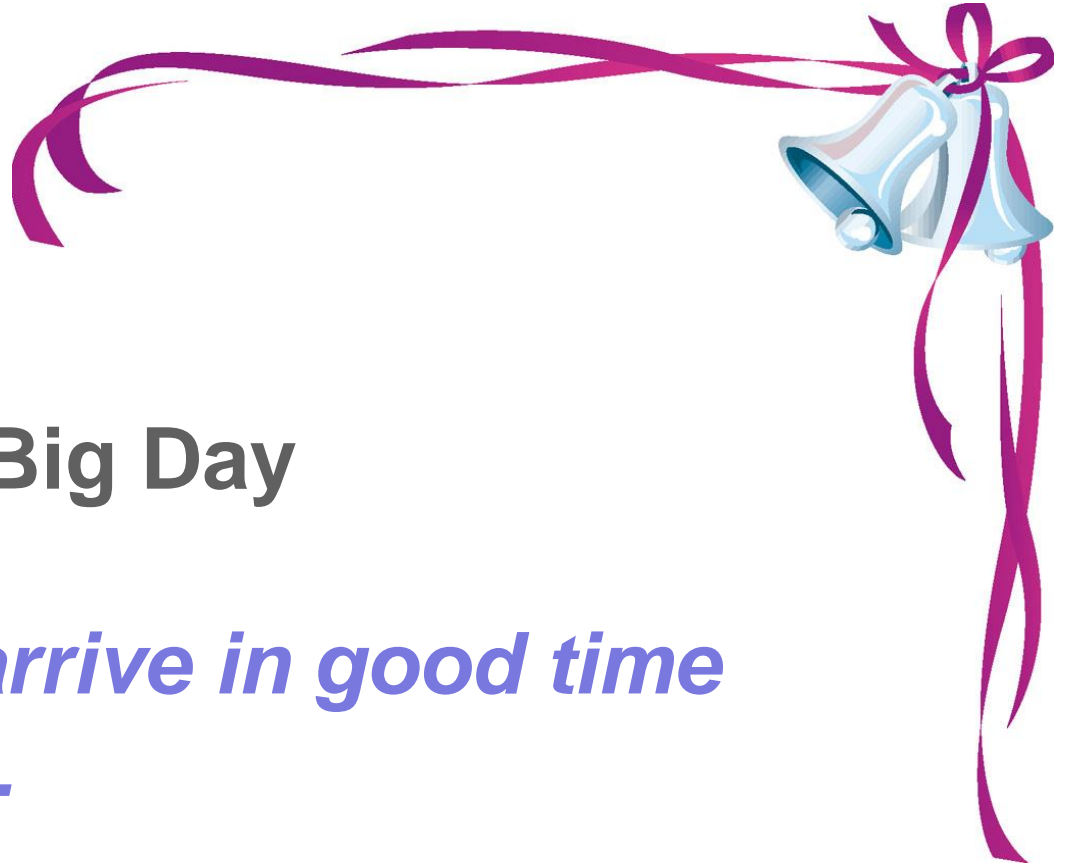

## Timings on the Big Day

*People should arrive in good time  
for the service...*

*Ushers – 30 mins before  
Groom & Best Man – 20 mins before*



## Timings

**Allow 50 minutes for the service  
and a further 30 minutes for the  
photographer!**



## Flowers

**We can't guarantee fresh flowers in church as they are provided on a voluntary basis Sunday by Sunday.**



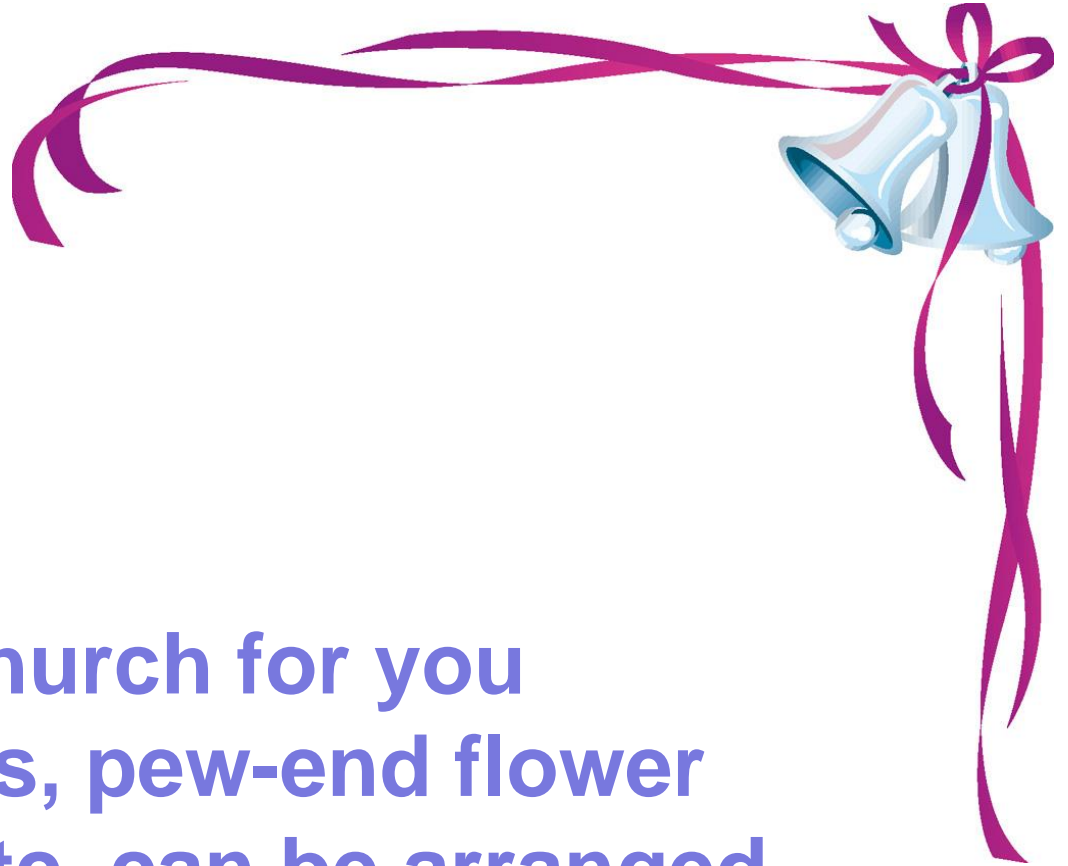

## Flowers

Access to the church for you to install ribbons, pew-end flower arrangements etc. can be arranged during the rehearsal.

*(Basford has 16 rows)*

*(Wolstanton has 9 rows before the aisle)*



## Photography

We have (at St. Mark's) a policy for you to hand to your photographer.

At Wolstanton we'll issue instructions to the photographer on the day.

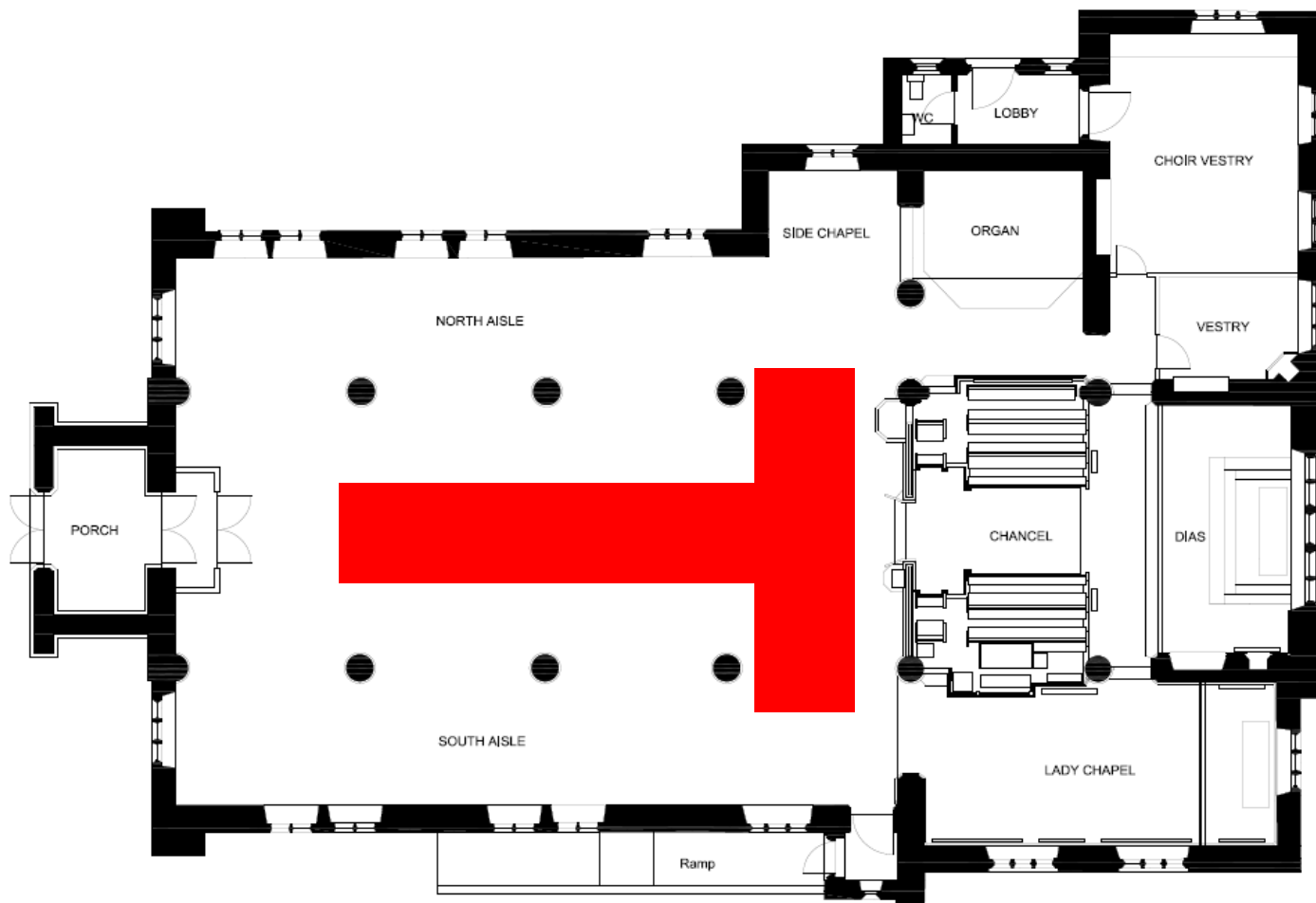



YOUR CHURCH

# WEDDING

A decorative flourish consisting of three stylized, symmetrical scroll-like elements that curve upwards and outwards from a central point.

**[www.yourchurchwedding.org](http://www.yourchurchwedding.org)**



**Handout**

**The Service (word-for-word).**



## Music

*It is possible to play CDs during the service but we need a separate CD burned for each required track.*

*Better not to burn them as MP3 files!*

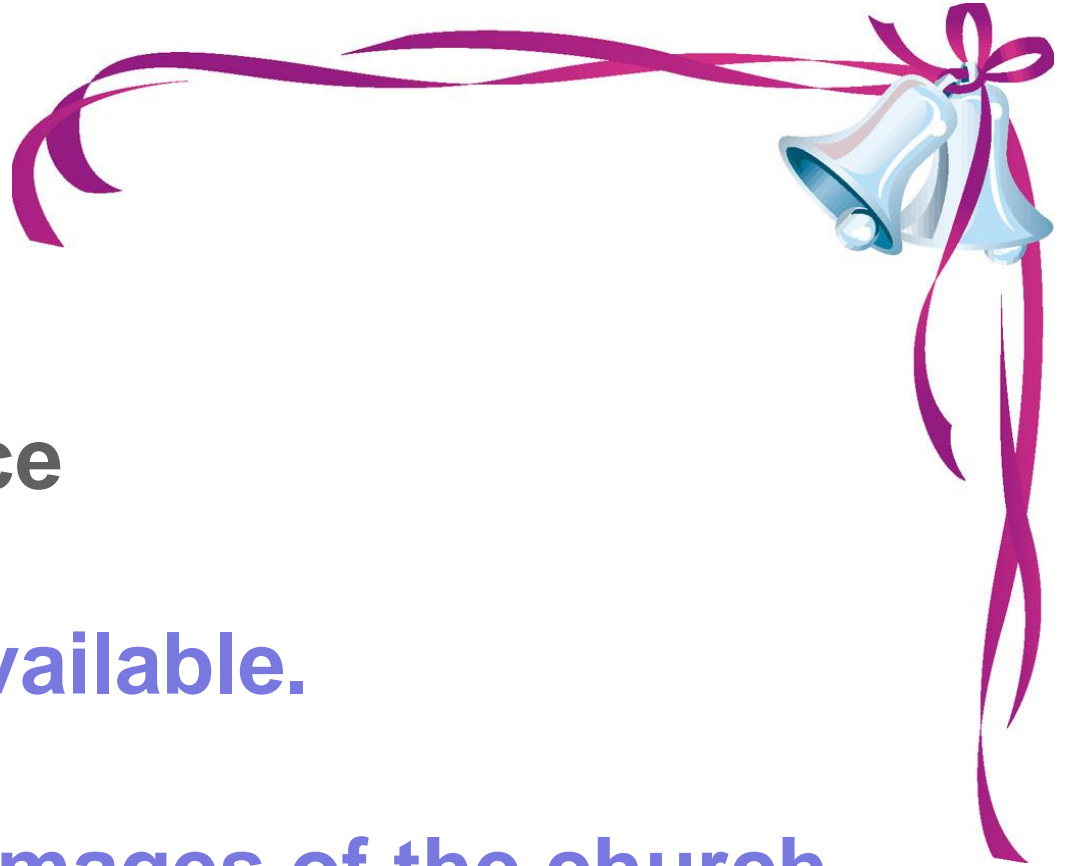

## **Orders of Service**

**Examples are available.**

**Hymn words & images of the church  
can be emailed allowing you to cut  
and paste them into your documents.**



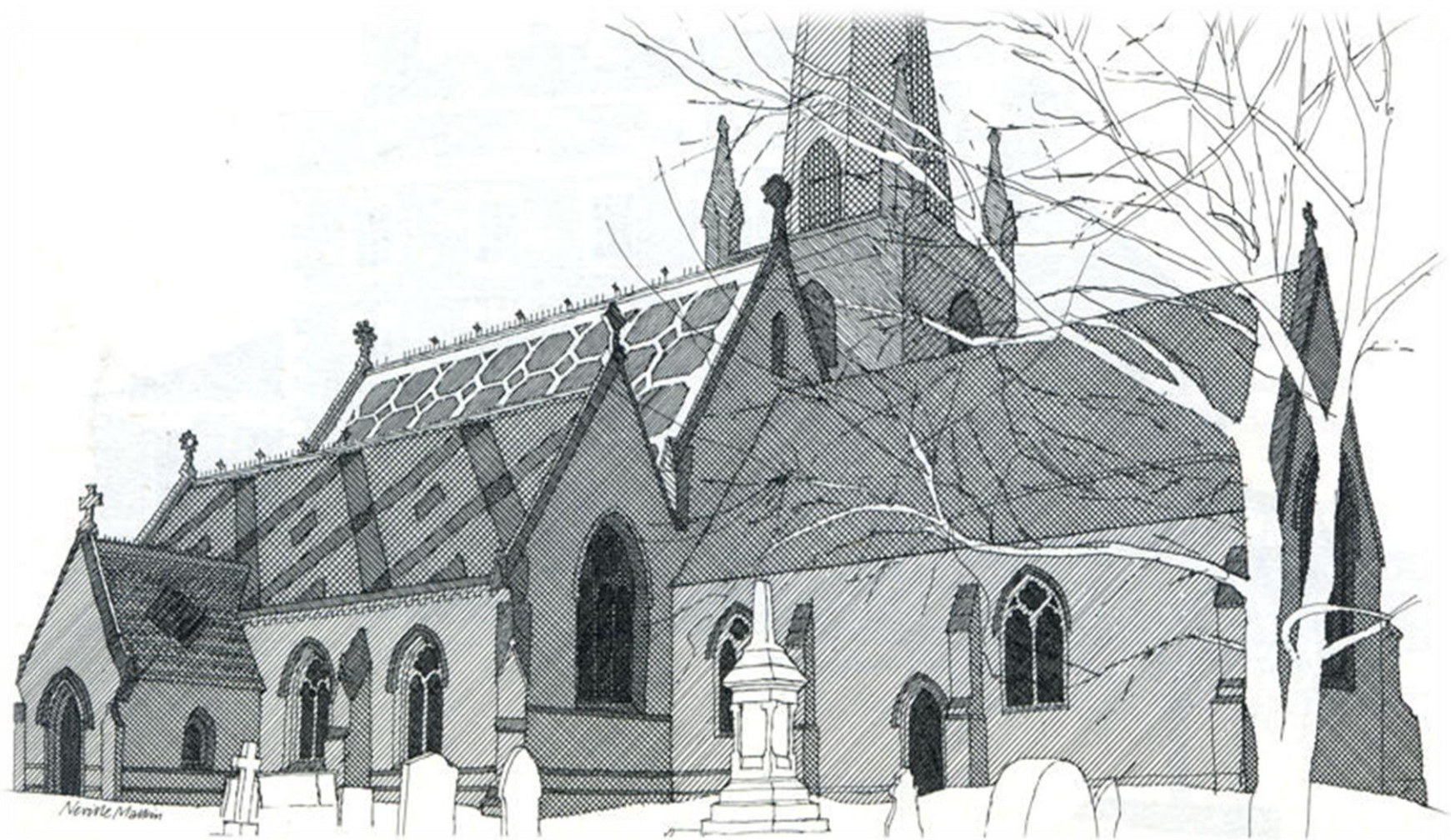



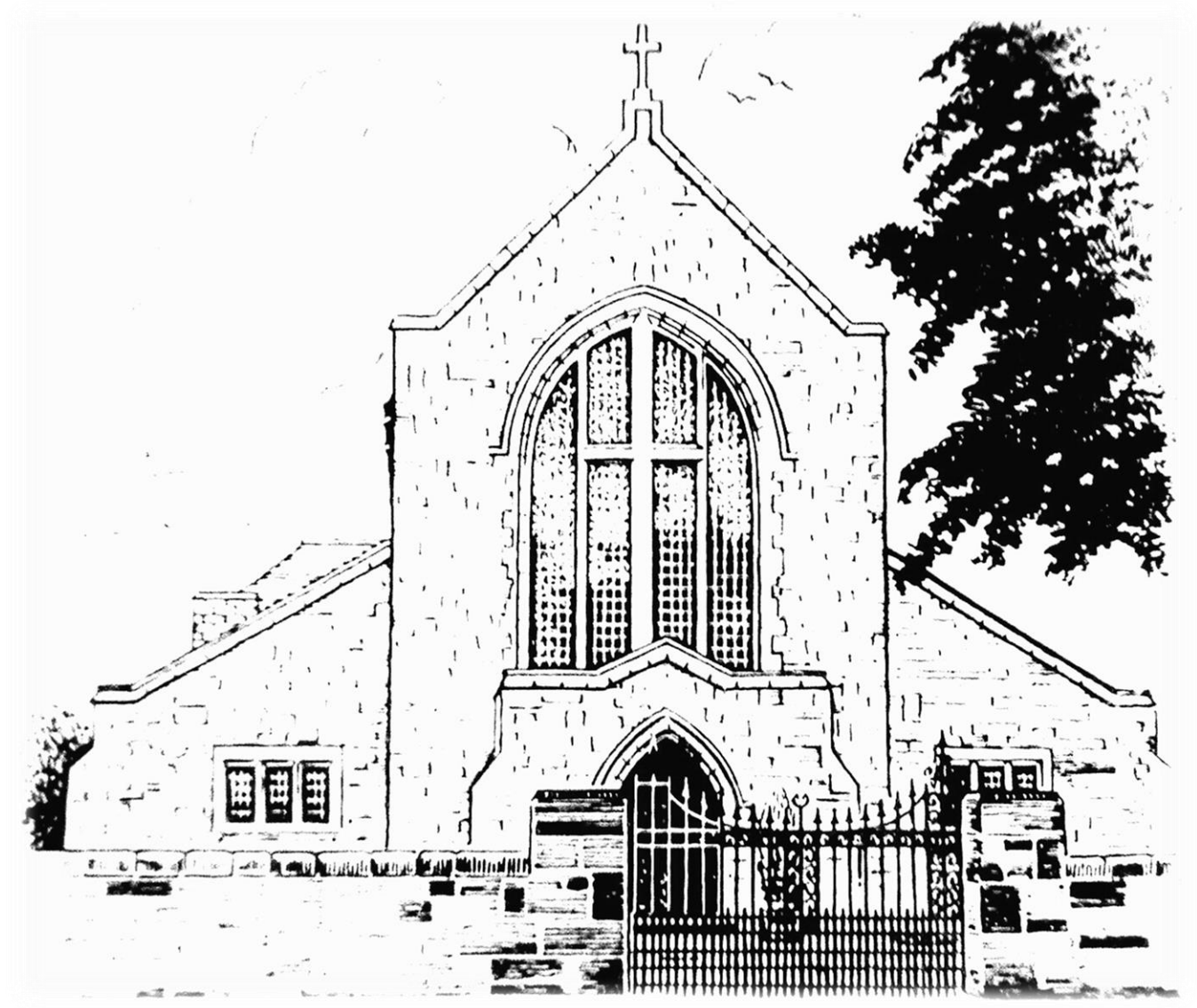



## Clergy Contacts

Fr Tommy Merry: 01782 624450

Rev'd Pat: 01782 846417



Visit us on  
Facebook



FOLLOW US ON  
twitter

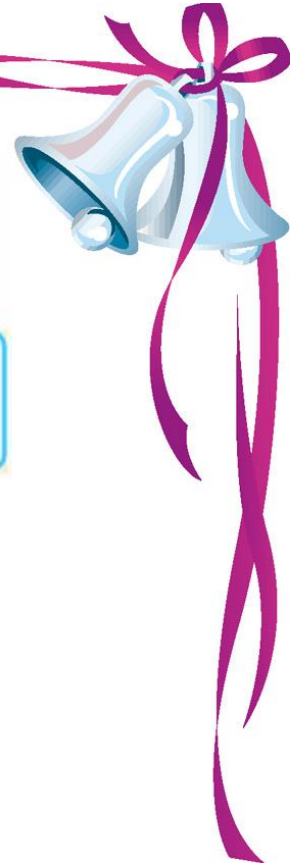

[www.stmarksbasford.co.uk](http://www.stmarksbasford.co.uk)

[www.stmargaretswolstanton.org](http://www.stmargaretswolstanton.org)



## **Alternative Contacts**

**Julie Atkins (Basford Administrator):**

**01782 632213**



YOUR CHURCH

# WEDDING



THE CHURCH  
OF ENGLAND

